

SERIES 3060 ALUMINUM WINDOW WALL SMALL MISSILE IMPACT (SMI)

GENERAL NOTES:

- THIS PRODUCT HAS BEEN DESIGNED AND TESTED TO COMPLY WITH THE REQUIREMENTS OF THE 6TH EDITION FLORIDA BUILDING CODE (2017) INCLUDING HIGH VELOCITY HURRICANE ZONE (HVHZ).
- WINDOW WALL RATED FOR SMALL MISSILE IMPACT. IMPACT RESISTANT SHUTTERS ARE REQUIRED FOR INSTALLATIONS UP TO 30 FT OF GRADE. SHUTTERS ARE NOT REQUIRED FOR INSTALLATIONS ABOVE 30 FT OF GRADE.
- THESE WINDOWS ARE APPROVED FOR AIR AND WATER INFILTRATION.
- ANCHORS SHALL BE AS LISTED, SPACED AS SHOWN ON DETAILS. ANCHORS EMBEDMENT TO BASE MATERIAL SHALL BE BEYOND WALL DRESSING OR STUCCO.
- ANCHORING OR LOADING CONDITIONS NOT SHOWN IN THESE DETAILS ARE NOT PART OF THIS APPROVAL.
- MATERIALS INCLUDING BUT NOT LIMITED TO STEEL/METAL SCREWS THAT COME INTO CONTACT WITH OTHER DISSIMILAR MATERIALS SHALL MEET THE REQUIREMENTS OF THE 6TH EDITION FLORIDA BUILDING CODE (2017) SECTION AS APPLICABLE.
- METAL STRUCTURES NOT BY CONTINENTAL GLASS SYSTEMS, LLC. TO BE DESIGNED TO SUPPORT THE LOADS IMPOSED BY THIS GLAZING SYSTEM AND TO TRANSFER SUCH LOADS TO THE BUILDING MAIN STRUCTURE.
- ULTIMATE LOAD OBTAINED FROM ASCE 7-10, MULTIPLY BY 0.6 SHALL BE LESS THAN OR EQUAL TO MAX. DESIGN LOAD IN THIS DOCUMENT. THE DESIGN LOADS SHOWN IN THIS DOCUMENT ARE ALLOWABLE DESIGN LOADS.

INSTRUCTIONS:

USE CHARTS AS FOLLOWS.

- STEP 1: DETERMINE DESIGN WIND LOAD REQUIREMENTS BASED ON WIND VELOCITY, BLDG. HEIGHT, WIND ZONE USING APPLICABLE ASCE 7-10 STANDARD.
- STEP 2: SEE TYPICAL ELEVATION ON SHEET E1 FOR MAXIMUM SIZES OF INCLINED JAMB
- STEP 3: SEE CHART 1 ON SHEET G1 FOR APPROVED GLASS TYPES AND DESIGN LOAD CAPACITIES BASED ON APPLICABLE WIND DURATION.
- STEP 4: CHECK MULLION AND JAMB CAPACITY FOR A GIVEN SPACING AND HEIGHT USING CHARTS ON SHEET M1 & M2. THE CAPACITY SHOULD EXCEED THE DESIGN LOAD.
- STEP 5: SELECT ANCHOR TYPE ON SHEET A2 AND CHECK ANCHOR CAPACITY ON SHEET A1. THE CAPACITY SHOULD EXCEED THE DESIGN LOAD.
- STEP 6: THE LOWEST VALUE RESULTING FROM STEPS 2, 3 AND 4 SHALL APPLY TO ENTIRE SYSTEM.

ABBREVIATIONS AND SYMBOLS	
D.L.O. - DAYLITE OPENING	CL - CENTER LINE
F.H. - FRAME HEIGHT	S.S. - STAINLESS STEEL
F.W. - FRAME WIDTH	H.S. - HEAT STRENGTHENED
LG. - LONG	SSG - STRUCTURAL SILICON GLAZED
STL. - STEEL	TEMP. - TEMPERED
ALUM. - ALUMINUM	O.C. - ON CENTER
MULL. - MULLION	SECTION NUMBER
HORIZ. - HORIZONTAL	
W/ - WITH	
W/O - WITHOUT	
VERT. - VERTICAL	



LIMITATIONS OF USE

A. THIS PRODUCT EVALUATION DOCUMENT (P.E.D.) PREPARED BY THIS ENGINEER IS GENERIC AND DOES NOT PROVIDE INFORMATION FOR A SITE SPECIFIC PROJECT, I.e. WHERE THE SITE CONDITIONS DEVIATE FROM THE P.E.D.

B. CONTRACTOR TO BE RESPONSIBLE FOR THE SELECTION, PURCHASE AND INSTALLATION OF THIS PRODUCT BASED ON THIS PRODUCT EVALUATION PROVIDED HE/SHE DOES NOT DEVIATE FROM THE CONDITIONS DETAILED ON THIS DOCUMENT.

C. THIS PRODUCT EVALUATION DOCUMENT WILL BE CONSIDERED INVALID IF ALTERED BY ANY MEANS.

D. SITE SPECIFIC PROJECTS SHALL BE PREPARED BY A FLORIDA REGISTERED ENGINEER OR ARCHITECT WHICH WILL BECOME THE ENGINEER OF RECORD (E.O.R.) FOR THE PROJECT AND WHO WILL BE RESPONSIBLE FOR THE PROPER USE OF THE P.E.D.

E. THIS P.E.D. SHALL BEAR THE DATE AND ORIGINAL SEAL AND SIGNATURE OF THE PROFESSIONAL ENGINEER OF RECORD AT THE TIME OF PREPARATION.

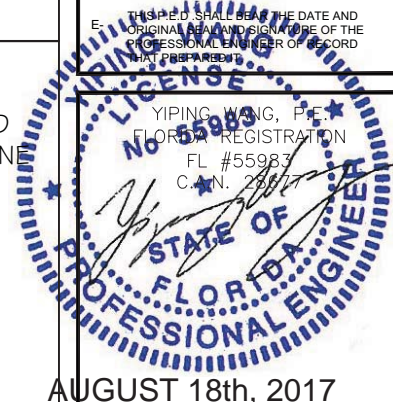

MCY ENGINEERING, INC.
GLAZING CONSULTANTS

8501 SW 124 Ave, Ste. 205A
MIAMI, FL 33183 P: 305.271.0117

www.MCYEngineering.com MCY.Engineering@Alt.net

SYSTEM 3060 WINDOW WALL - S.M.I.

CONTINENTAL GLASS SYSTEMS, INC.
325 WEST 74 PLACE, HIALEAH, FL 33014
TEL: (305) 231-1101 FAX: (305) 231-1103

Rev. No.	Date	Drawn By	Description

Drawn Date: 07/27/2017 Scale: Rev. No. Date Description

FL #22012 DRAWING NO. AD17-09

COVER

Sheet No. 1 OF 15

AUGUST 18th, 2017

GLASS CAPACITIES (PSF)

D.L.O. WIDTH (IN.)	D.L.O. HEIGHT (IN.)	GLASS TYPE 'G1' & 'G2'	
		(+PSF)	(- PSF)
50	90	120.0	160.0
56		120.0	160.0
62		120.0	160.0
68		120.0	160.0
50	96	120.0	160.0
56		120.0	160.0
62		120.0	160.0
68		120.0	160.0
44	102	120.0	160.0
50		120.0	160.0
56		120.0	160.0
68		120.0	130.0
44	108	120.0	160.0
50		120.0	160.0
56		120.0	160.0
62		120.0	130.0
44	114	120.0	160.0
50		120.0	160.0
56		120.0	160.0
60		120.0	130.0
38	120	120.0	160.0
44		120.0	160.0
50		120.0	160.0
56		120.0	130.0
38	126	120.0	160.0
44		120.0	160.0
50		120.0	160.0
54		120.0	130.0
38	132	120.0	160.0
44		120.0	160.0
50		120.0	130.0
52		120.0	130.0
32	138	120.0	160.0
38		120.0	160.0
44		120.0	160.0
50		120.0	130.0
32	144	120.0	160.0
38		120.0	160.0
44		120.0	160.0
48		120.0	130.0
32	149	120.0	160.0
38		120.0	160.0
44		120.0	130.0
46		120.0	130.0

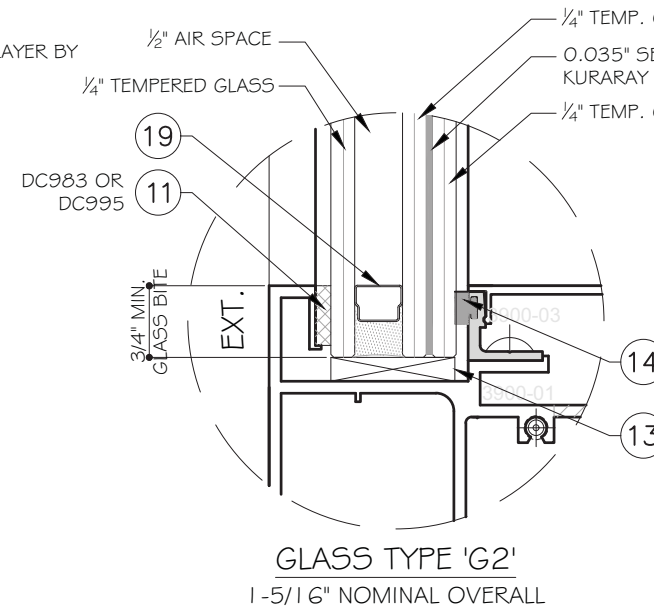
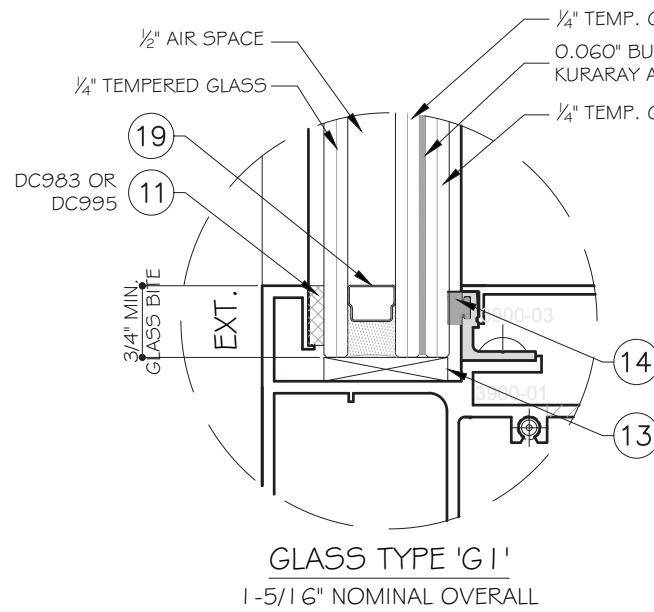

NOTE:
GLASS COMPLIES WITH ASTM E 1300-09
(3 SEC. GUSTS).

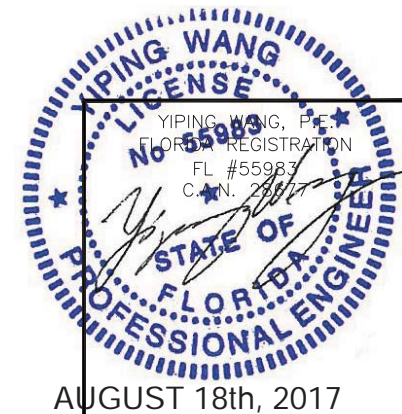

MCY ENGINEERING, INC.
GLAZING CONSULTANTS
8501 SW 124 Ave., Ste. 205A
MIAMI, FL 33183
P: 305.271.0117
www.MCYEngineering.com
MCY.Engineering@All.net

SYSTEM 3060 WINDOW WALL - S.M.I.
CONTINENTAL GLASS SYSTEMS, INC.
325 WEST 74 PLACE, HIALEAH, FL 33014
TEL: (305) 231-1101 FAX: (305) 231-1103

Drawn Date	Scale	Rev. No.	Date	Drawn By	Description
07/27/2017					
FL #22012					
DRAWING NO. AD17-09					
G1					
Sheet No. 4 OF 15					

DESIGN LOAD CAPACITY WITH HORIZONTAL- PSF					
MULLION DIMENSION		UNREINFORCED J1, J2, J3, M1		REINFORCED J2, J3, M1	
MULLION WIDTH (IN)	MULLION HEIGHT (IN)	EXT. (+)	INT. (-)	EXT. (+)	INT. (-)
60	96	120.0	130.0	120.0	160.0
66		120.0	130.0	120.0	160.0
72		120.0	130.0	120.0	160.0
60	102	120.0	130.0	120.0	160.0
66		120.0	130.0	120.0	160.0
72		120.0	130.0	-	-
54	108	120.0	130.0	120.0	160.0
60		120.0	130.0	120.0	160.0
66		120.0	130.0	120.0	160.0
54	114	120.0	130.0	120.0	160.0
60		120.0	130.0	120.0	160.0
66		120.0	130.0	-	-
48	120	120.0	130.0	120.0	160.0
54		120.0	130.0	120.0	160.0
60		120.0	130.0	120.0	152.0
48	126	120.0	130.0	120.0	160.0
54		120.0	130.0	120.0	153.0
60		120.0	120.0	-	-
42	132	120.0	130.0	120.0	160.0
48		120.0	130.0	120.0	157.0
54		120.0	122.0	120.0	140.0
42	138	120.0	130.0	120.0	160.0
48		120.0	125.0	120.0	144.0
54		111.0	111.0	-	-
36	144	120.0	130.0	120.0	160.0
42		120.0	125.0	120.0	151.0
48		111.0	111.0	120.0	132.0
36	150	120.0	130.0	120.0	160.0
42		112.0	112.0	120.0	139.0
48		98.0	98.0	120.0	122.0
30	155	120.0	130.0	120.0	160.0
36		119.0	119.0	120.0	152.0
42		102.0	102.0	120.0	130.0
48		89.0	89.0	-	-

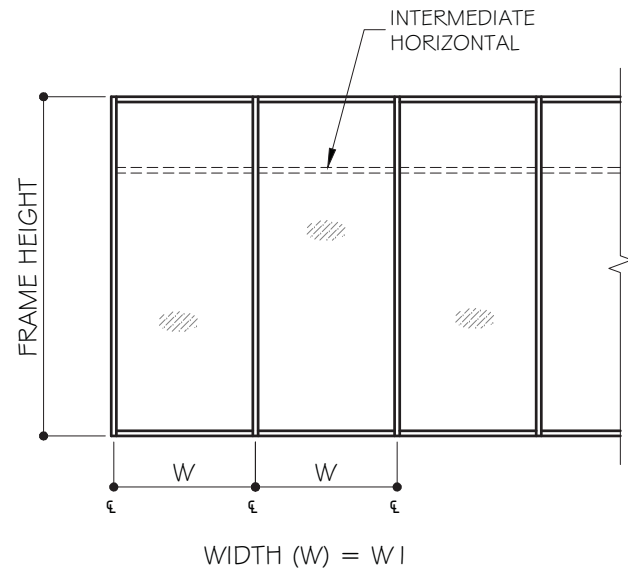

M1	Ix IN^4	Sx IN^3
3060-04	13.1940	4.2804
3060-05	12.6869	4.1685
1/2"x5" STL BAR	11.011	(IN ALUM.)
1/2"x4.5" STL BAR	15.1041	(IN ALUM.)
TOTAL	51.9960	

M1	Ix IN^4	Sx IN^3
3060-04	13.1940	4.2804
3060-05	12.6869	4.1685
TOTAL	25.8809	8.3963

NOTE: UNREINF. OR REINFORCED (J1), (J2), (J3) SEE SHEET M1.

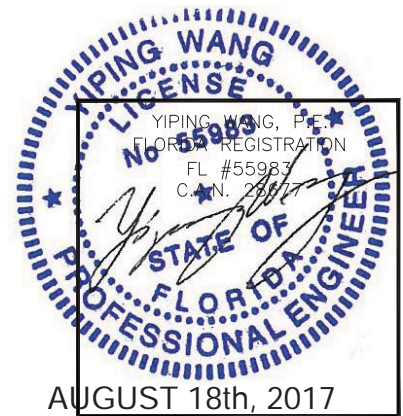

MCY ENGINEERING, INC. GLAZING CONSULTANTS		8501 SW 124 Ave, Ste. 205A MIAMI, FL 33183 P: 305.271.0117	www.MCYEngineering.com MCY.Engineering@Alt.net
SYSTEM 3060 WINDOW WALL - S.M.I.		CONTINENTAL GLASS SYSTEMS, INC. 325 WEST 74 PLACE, HIALEAH, FL 33014 TEL: (305) 231-1101 FAX: (305) 231-1103	
Drawn Date	Scale	Drawn By	Description
07/27/2017			
FL #22012		DRAWING NO.	
		AD17-09	
		M2	
AUGUST 18th, 2017		Sheet No.	
		6 OF 15	

ANCHOR CAPACITY - PSF							
NOMINAL DIMENSION		A3	A4	AA3	AA4	B3	B4
MULLION WIDTH (IN.) (W)	FRAME HEIGHT (IN.) (L)	EXT. (+) INT. (-)	EXT. (+) INT. (-)	EXT. (+) INT. (-)	EXT. (+) INT. (-)	EXT. (+) INT. (-)	EXT. (+) INT. (-)
48	90	160.0	160.0	160.0	160.0	160.0	160.0
54		148.6	160.0	160.0	160.0	160.0	160.0
60		133.8	160.0	156.8	160.0	160.0	160.0
66		121.6	160.0	142.5	160.0	160.0	160.0
72		111.5	148.6	130.7	160.0	152.8	160.0
48	96	156.8	160.0	160.0	160.0	160.0	160.0
54		139.3	160.0	160.0	160.0	160.0	160.0
60		125.4	160.0	147.0	160.0	160.0	160.0
66		114.0	152.0	133.6	160.0	156.3	160.0
72		104.5	139.3	122.5	160.0	143.3	160.0
48	102	147.5	160.0	160.0	160.0	160.0	160.0
54		131.1	160.0	153.7	160.0	160.0	160.0
60		118.0	157.4	138.4	160.0	160.0	160.0
66		107.3	143.1	125.8	160.0	147.1	160.0
72		98.4	131.1	115.3	153.7	134.8	160.0
42	108	159.2	160.0	160.0	160.0	160.0	160.0
48		139.3	160.0	160.0	160.0	160.0	160.0
54		123.9	160.0	145.2	160.0	160.0	160.0
60		111.5	148.6	130.7	160.0	152.8	160.0
66		101.3	135.1	118.8	158.4	138.9	160.0
42	114	150.9	160.0	160.0	160.0	160.0	160.0
48		132.0	160.0	154.7	160.0	160.0	160.0
54		117.3	156.4	137.5	160.0	160.0	160.0
60		105.6	140.8	123.8	160.0	144.8	160.0
66		96.0	128.0	112.5	150.0	131.6	160.0
36	120	160.0	160.0	160.0	160.0	160.0	160.0
42		143.3	160.0	160.0	160.0	160.0	160.0
48		125.4	160.0	147.0	160.0	160.0	160.0
54		111.5	148.6	130.7	160.0	152.8	160.0
60		100.3	133.8	117.6	156.8	137.5	160.0
36	126	159.2	160.0	160.0	160.0	160.0	160.0
42		136.5	160.0	160.0	160.0	160.0	160.0
48		119.4	159.2	140.0	160.0	160.0	160.0
54		106.2	141.5	124.4	160.0	145.5	160.0
60		95.5	127.4	112.0	149.3	131.0	160.0
36	132	152.0	160.0	160.0	160.0	160.0	160.0
42		130.3	160.0	152.7	160.0	160.0	160.0
48		114.0	152.0	133.6	160.0	156.3	160.0
54		101.3	135.1	118.8	158.4	138.9	160.0

ANCHOR CAPACITY - PSF							
NOMINAL DIMENSION		A3	A4	AA3	AA4	B3	B4
MULLION WIDTH (IN.) (W)	FRAME HEIGHT (IN.) (L)	EXT. (+) INT. (-)	EXT. (+) INT. (-)	EXT. (+) INT. (-)	EXT. (+) INT. (-)	EXT. (+) INT. (-)	EXT. (+) INT. (-)
36	138	145.4	160.0	160.0	160.0	160.0	160.0
42		124.6	160.0	146.1	160.0	160.0	160.0
48		109.0	145.4	127.8	160.0	149.5	160.0
54		96.9	129.2	113.6	151.5	132.9	160.0
36	144	139.3	160.0	160.0	160.0	160.0	160.0
42		119.4	159.2	140.0	160.0	160.0	160.0
48		104.5	139.3	122.5	160.0	143.3	160.0
36	150	133.8	160.0	156.8	160.0	160.0	160.0
42		114.7	152.9	134.4	160.0	157.2	160.0
48		100.3	133.8	117.6	156.8	137.5	160.0
36	155	129.4	160.0	151.7	160.0	160.0	160.0
42		111.0	147.9	130.1	160.0	152.1	160.0
48		97.1	129.4	113.8	151.7	133.1	160.0

TYPICAL ANCHORS: SEE SHEET A2 FOR DESCRIPTION

- A3 - (3) ANCHORS TYPE "A" AT EACH SIDE OF JAMB/MULLION
- A4 - (4) ANCHORS TYPE "A" AT EACH SIDE OF JAMB/MULLION
- AA3 - (3) ANCHORS TYPE "AA" AT EACH SIDE OF JAMB/MULLION
- AA4 - (4) ANCHORS TYPE "AA" AT EACH SIDE OF JAMB/MULLION
- B3 - (3) ANCHORS TYPE "B" AT EACH SIDE OF JAMB/MULLION
- B4 - (4) ANCHORS TYPE "B" AT EACH SIDE OF JAMB/MULLION

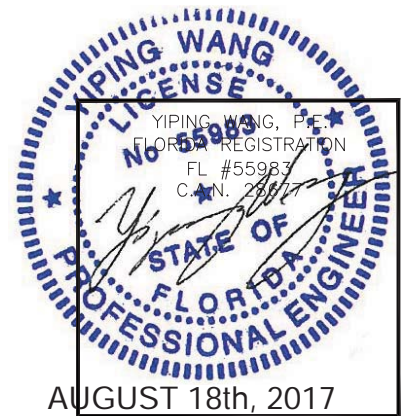

MCY ENGINEERING, INC.
GLAZING CONSULTANTS
8501 SW 124 Ave., Ste. 205A
MIAMI, FL 33183
P: 305.271.0117
www.MCYEngineering.com
MCY.Engineering@Att.net

SYSTEM 3060 WINDOW WALL - S.M.I.
CONTINENTAL GLASS SYSTEMS, INC.
325 WEST 74 PLACE, HIALEAH, FL 33014
TEL: (305) 231-1101 FAX: (305) 231-1103

Drawn Date	Scale	Rev. No.	Date	Drawn By	Description
07/27/2017					
FL #22012					
DRAWING NO. AD17-09					
A1					
Sheet No. 7 OF 15					

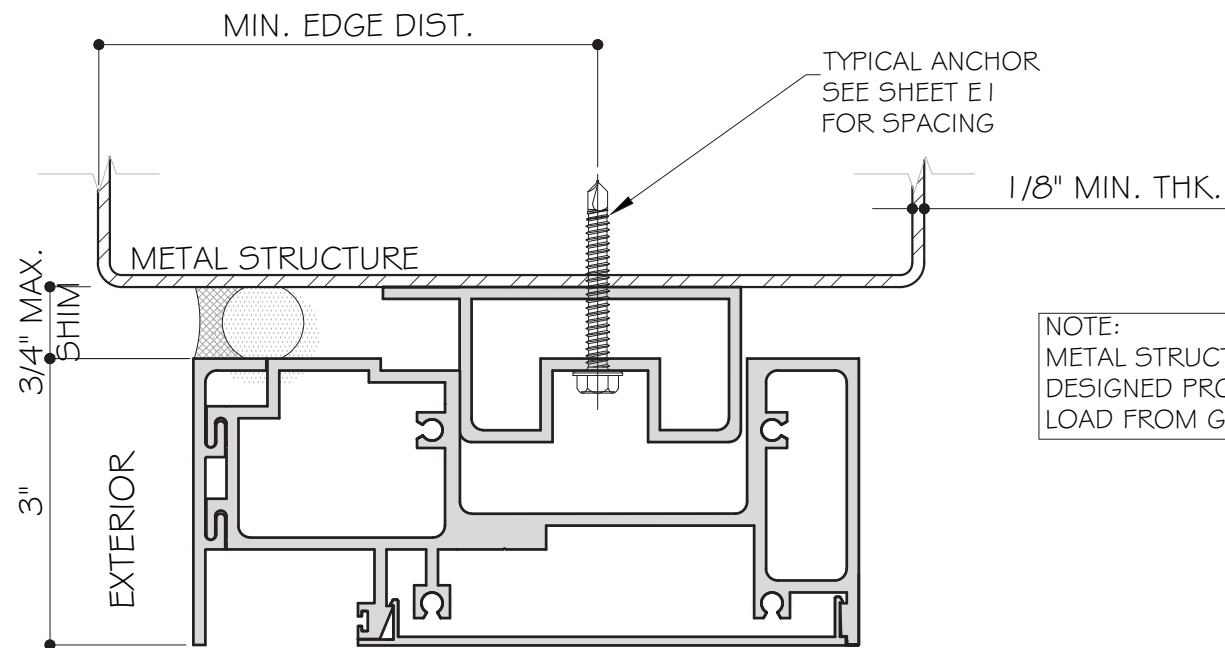
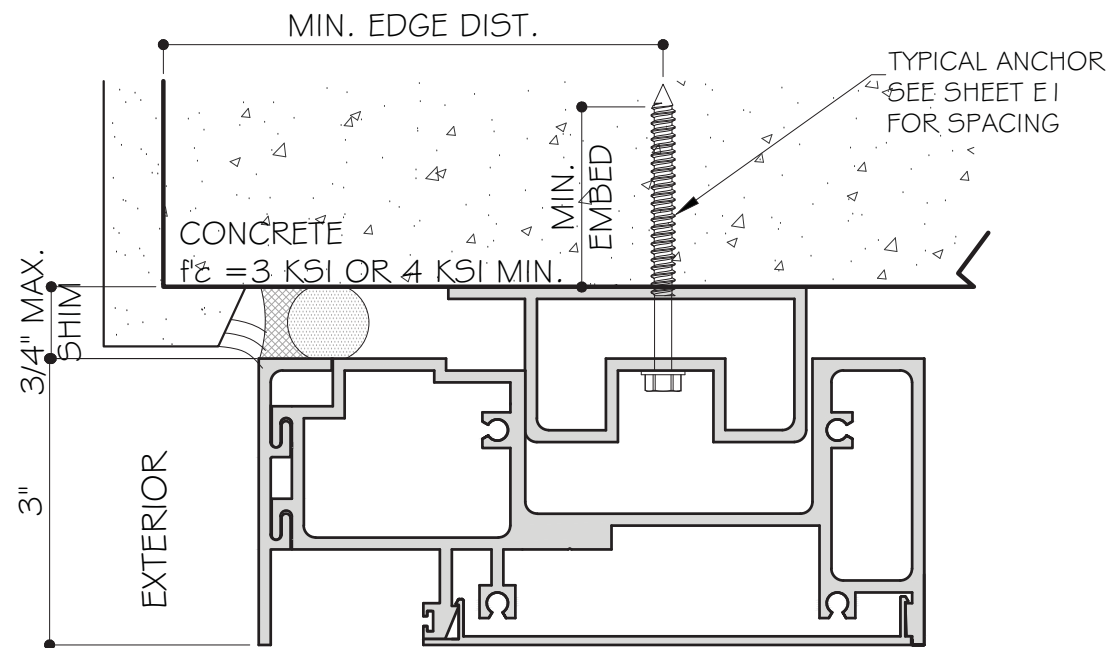

NOTE:
METAL STRUCTURE BY OTHERS TO BE
DESIGNED PROPERLY TO SUSTAIN THE
LOAD FROM GLAZING SYSTEM.

TYPICAL ANCHORS AT HEAD & SILL:

- TYPE "A": 5/16" DIA. ULTRACON ($F_u = 177$ KSI, $F_y = 155$ KSI)
1-3/4" MIN. EMBED DIRECTLY INTO $f_c' = 3$ KSI MIN. CONCRETE
3" MIN. EDGE DISTANCE
@ 3" MIN. O.C.
- TYPE "AA": 5/16" DIA. ULTRACON ($F_u = 177$ KSI, $F_y = 155$ KSI)
1-3/4" MIN. EMBED DIRECTLY INTO $f_c' = 4$ KSI MIN. CONCRETE
3" MIN. EDGE DISTANCE
@ 3" MIN. O.C.
- TYPE "B": 5/16" TEKS OR SELF DRILLING SCREW (GRADE 5) ($F_u = 120$ KSI, $F_y = 92$ KSI)
INTO 1/8" MIN. ALUM. STRUCTURE (6063-T5 MIN.)
@ 3" MIN. O.C.

-SEALANTS:

ALL FRAME CORNERS, JOINTS, MULLION SEAMS AND PERIMETER
GLAZING BEAD TO FRAME INSTALLATION FASTENERS SEALED WITH
SILICON SEALANT.

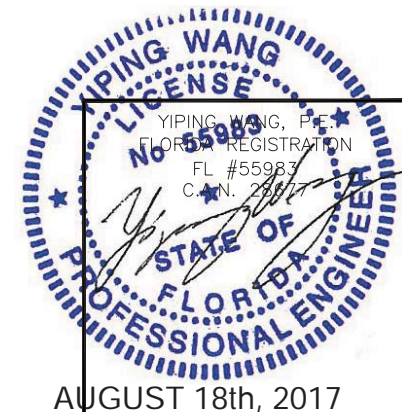

AUGUST 18th, 2017

MCY ENGINEERING, INC.
GLAZING CONSULTANTS
8501 SW 124 Ave, Ste. 205A
MIAMI, FL 33183
P: 305.271.0117
www.MCYEngineering.com
MCY.Engineering@Alt.net

SYSTEM 3060 WINDOW WALL - S.M.I.
CONTINENTAL GLASS SYSTEMS, INC.
325 WEST 74 PLACE, HIALEAH, FL 33014
TEL: (305) 231-1101 FAX: (305) 231-1103

Rev. No.	Date	Drawn By	Description

Drawn Date: 07/27/2017 Scale: FL #22012
DRAWING NO. AD17-09
A2
Sheet No. 8 OF 15

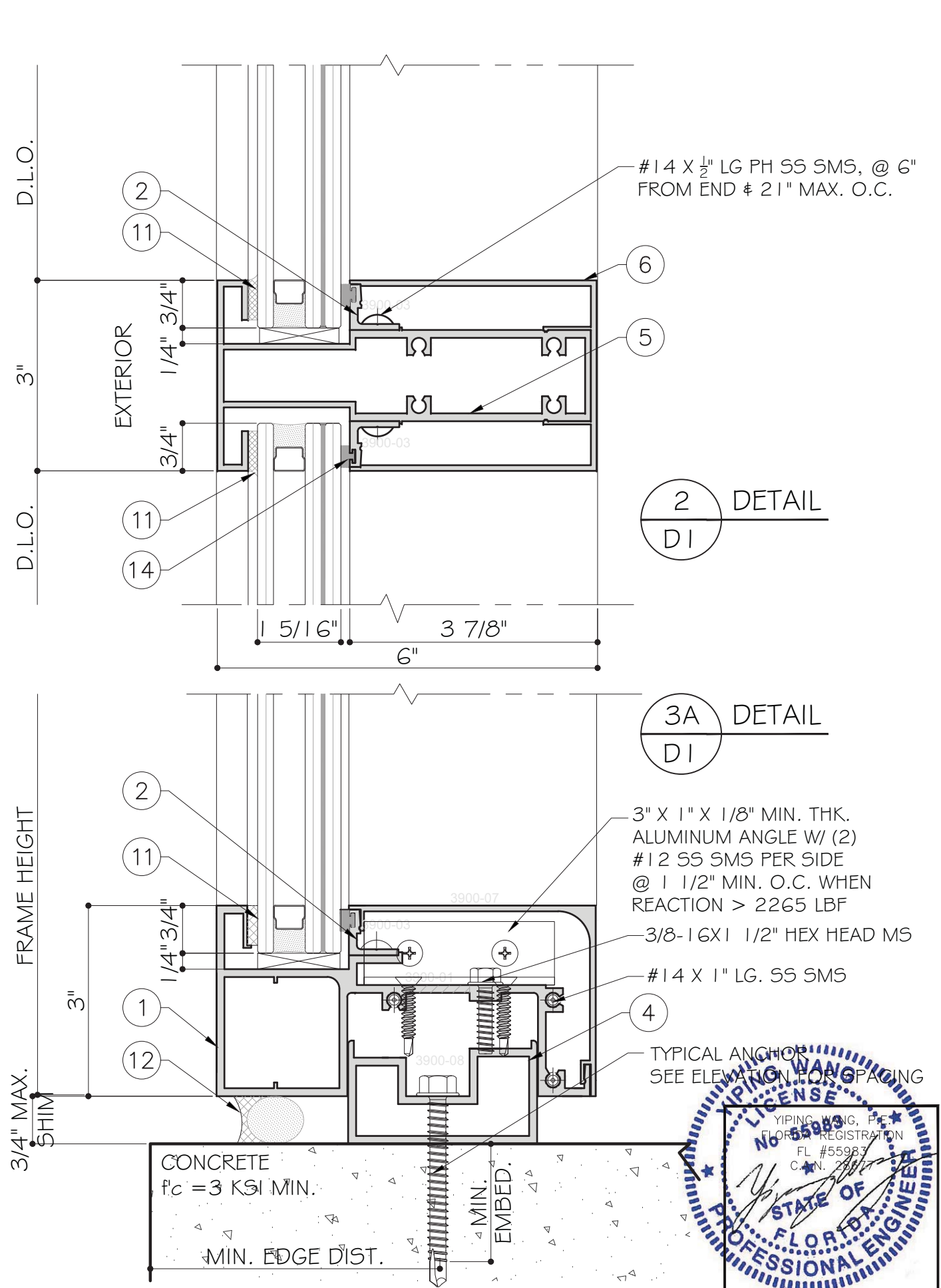
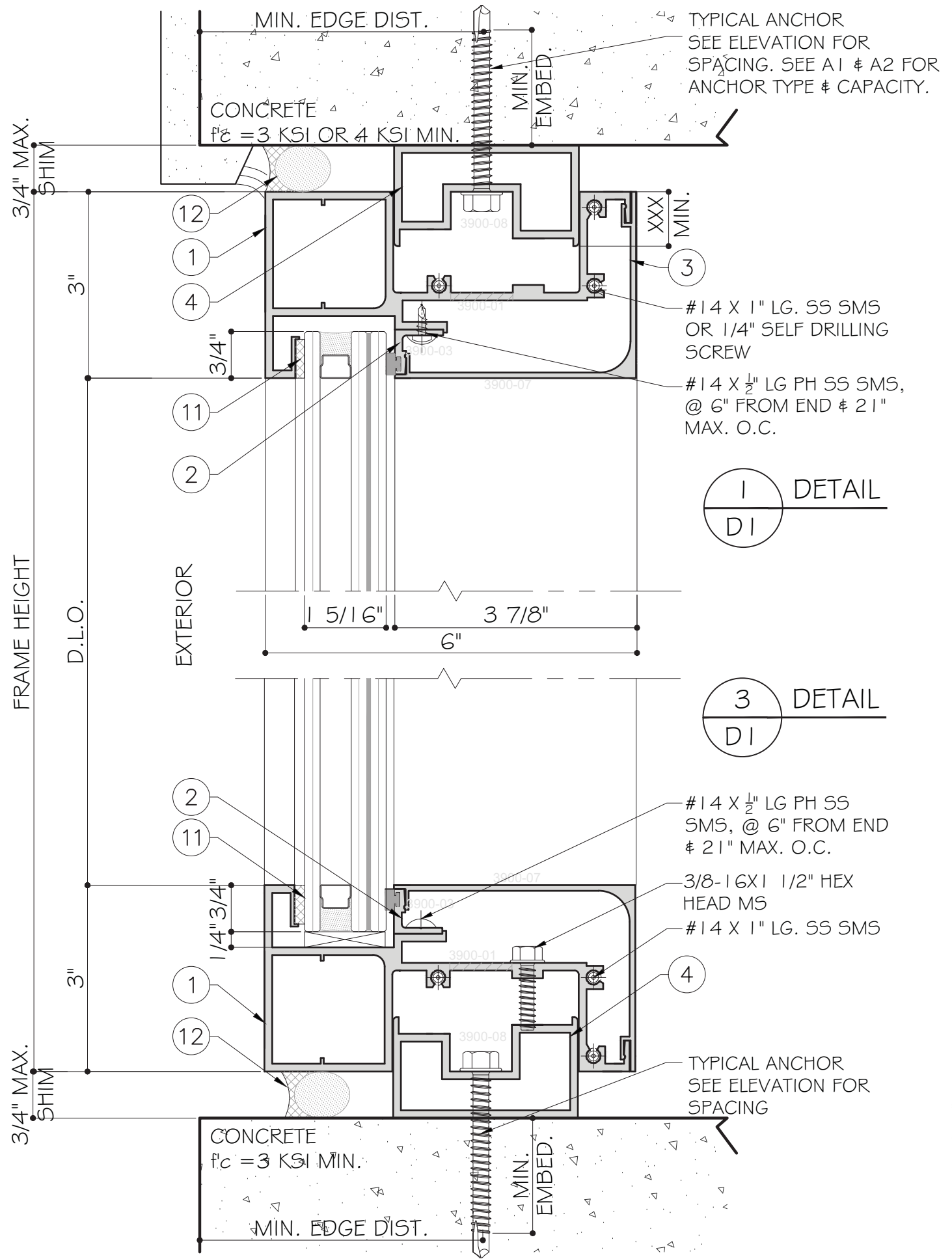

Rev. No.	Date	Drawn By	Description

Drawn Date: 07/27/2017 Scale:

FL #22012

DRAWING NO. AD17-09

D1

Sheet No. 9 OF 15

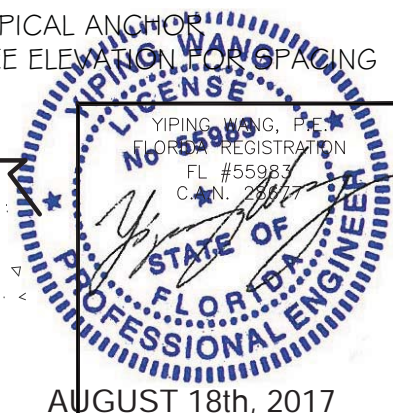

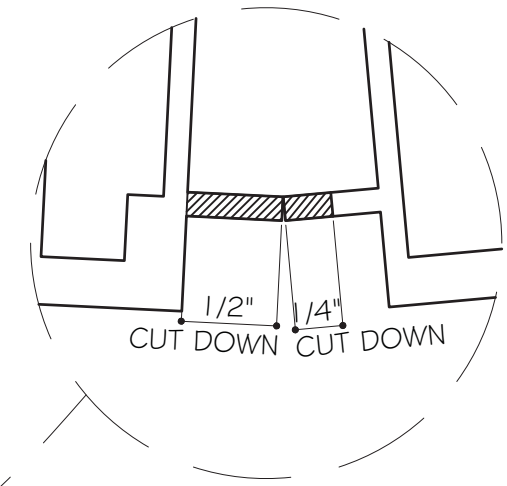
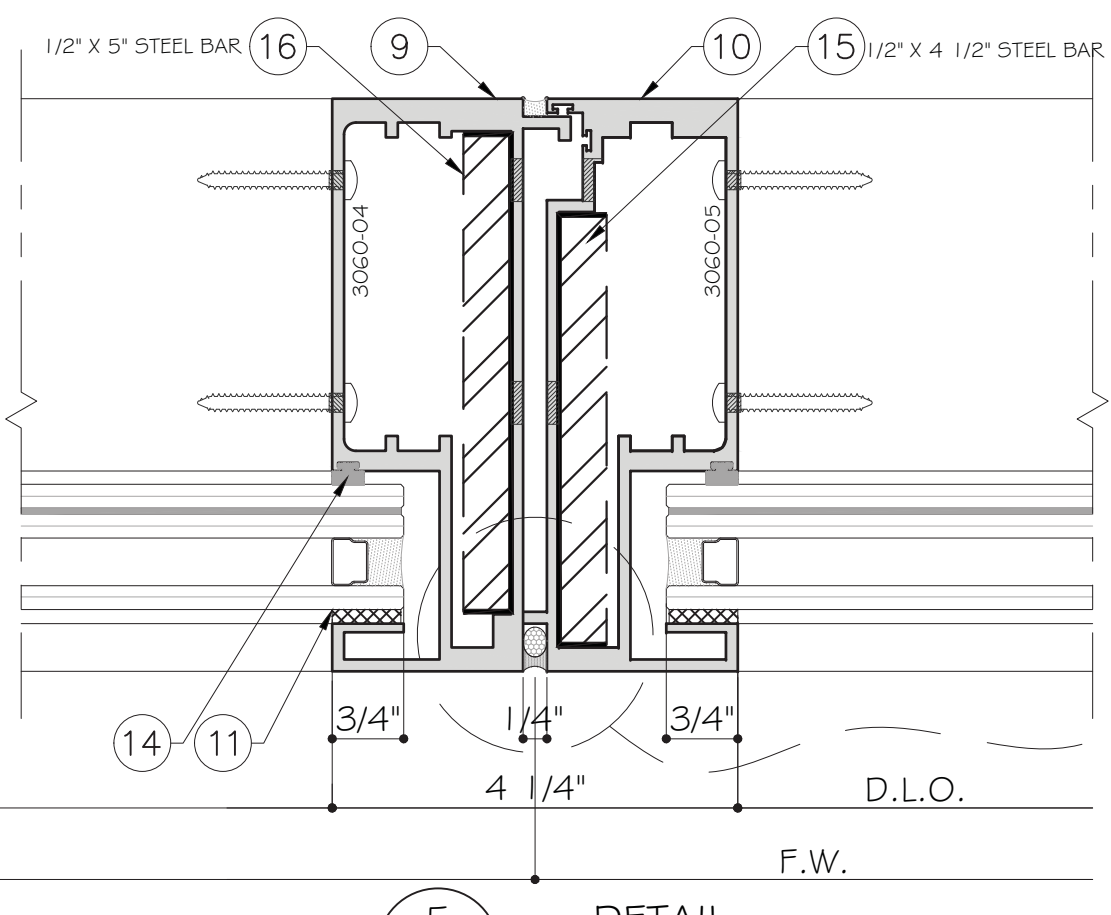
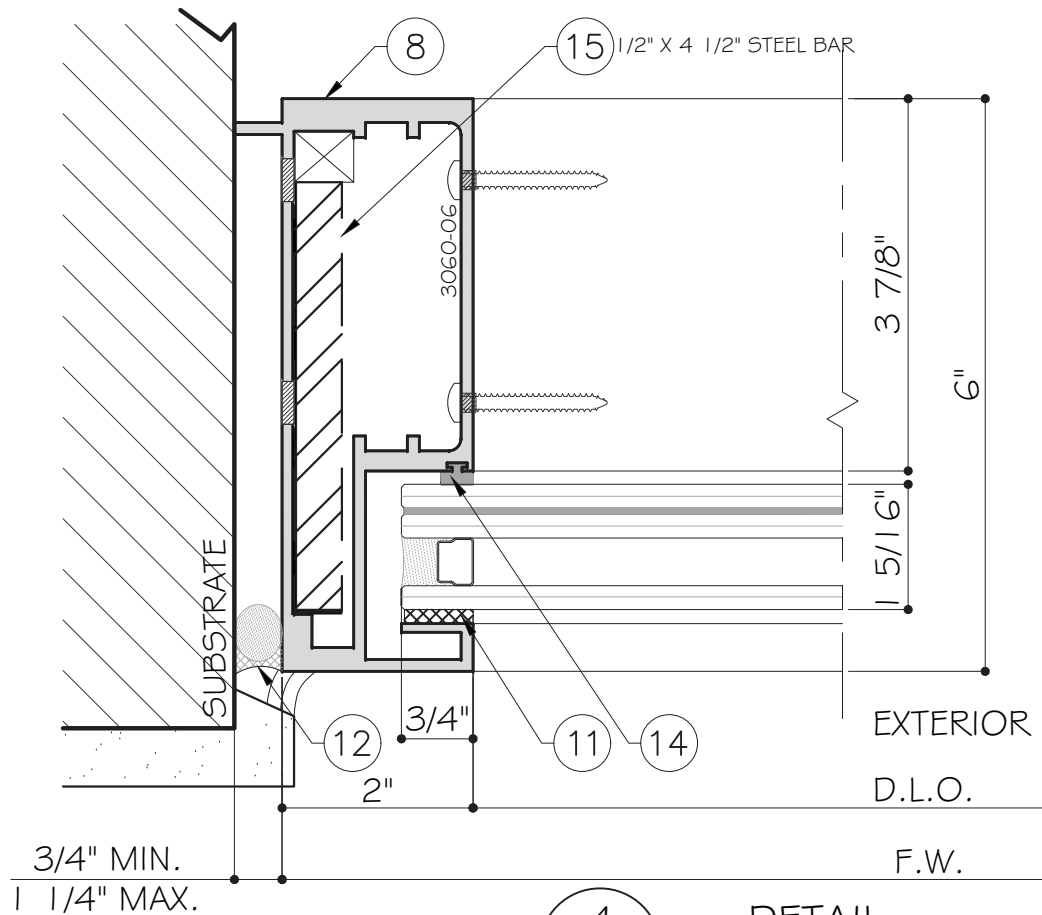

3/4" MIN.
1 1/4" MAX.

4 DETAIL
D2 W/ OR W/O REINF.

5 DETAIL
D2 W/ OR W/O REINF.

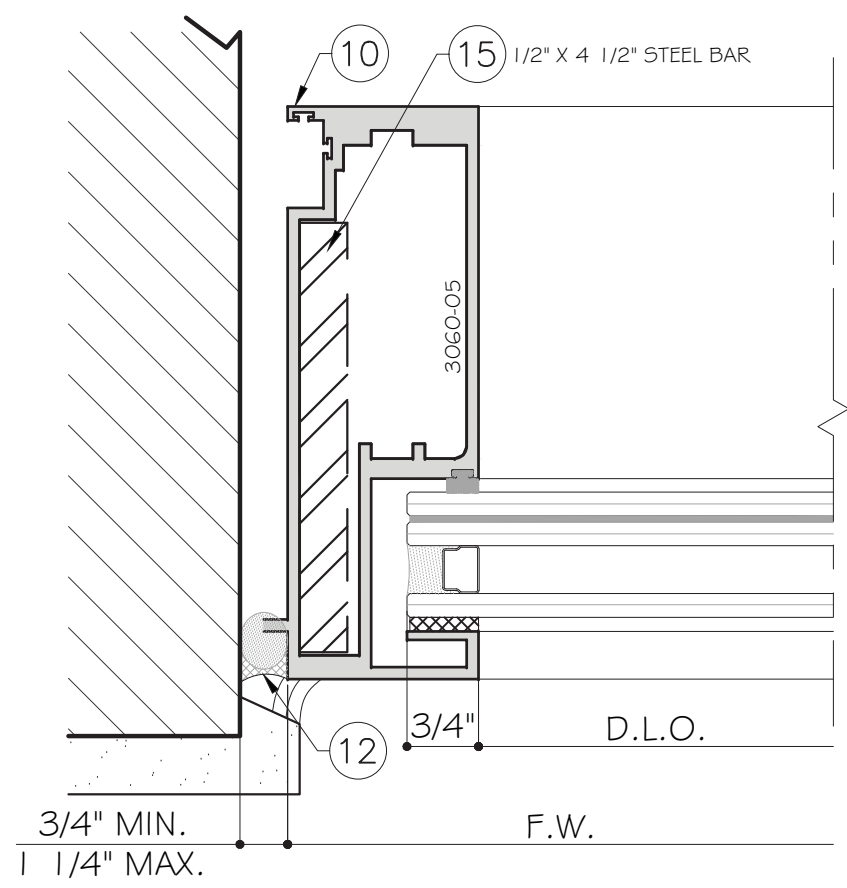

4 DETAIL
D2 OPTION
W/ OR W/O REINF.

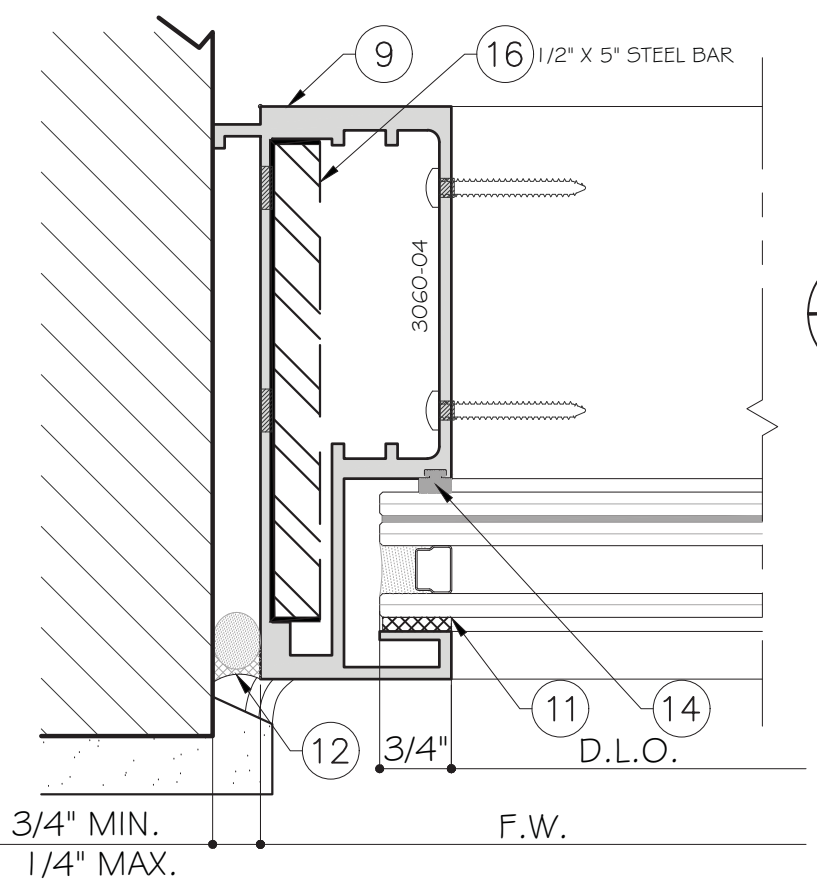

4 DETAIL
D2 OPTION
W/ OR W/O REINF.

3/4" MIN.
1 1/4" MAX.

3/4" MIN.
1 1/4" MAX.

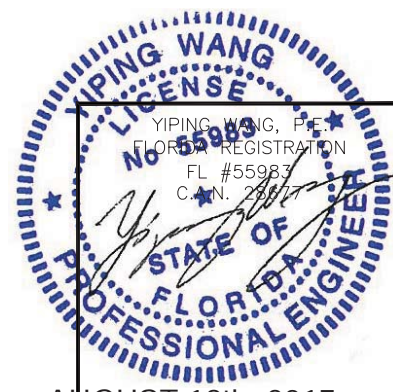

SYSTEM 3060 WINDOW WALL - S.M.I.
CONTINENTAL GLASS SYSTEMS, INC.
325 WEST 74 PLACE, HIALEAH, FL 33014
TEL: (305) 231-1101 FAX: (305) 231-1103

MCY ENGINEERING, INC.
GLAZING CONSULTANTS
8501 SW 124 Ave. Ste. 205A
MIAMI, FL 33183
P: 305.271.0117
www.MCYEngineering.com
MCY.Engineering@Alt.net

Rev. No.	Date	Drawn By	Description

Drawn Date	Scale
07/27/2017	
FL #22012	
DRAWING NO.	
AD17-09	
D2	
Sheet No.	
10 OF 15	

AUGUST 18th, 2017

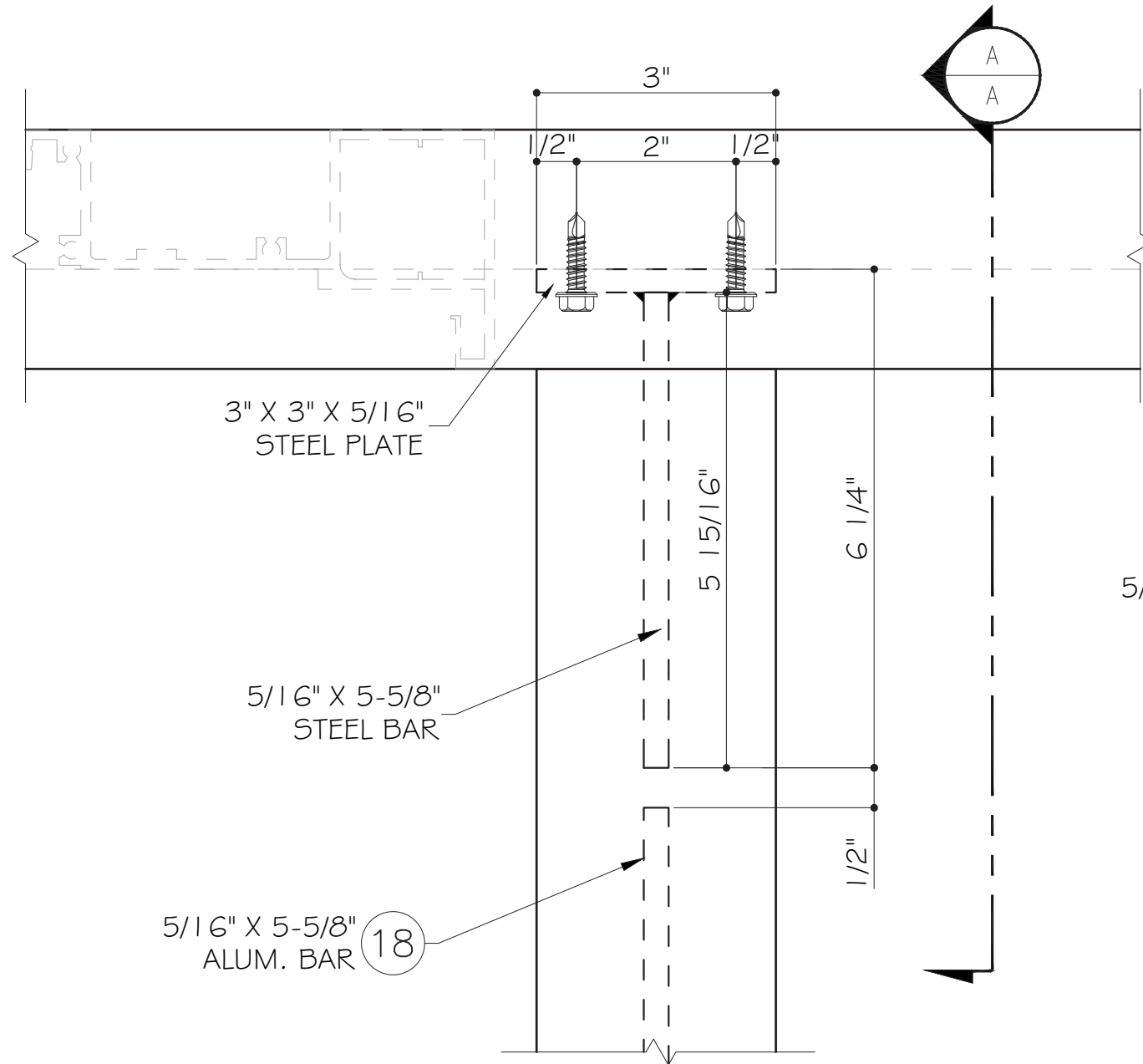

9 DETAIL
D4

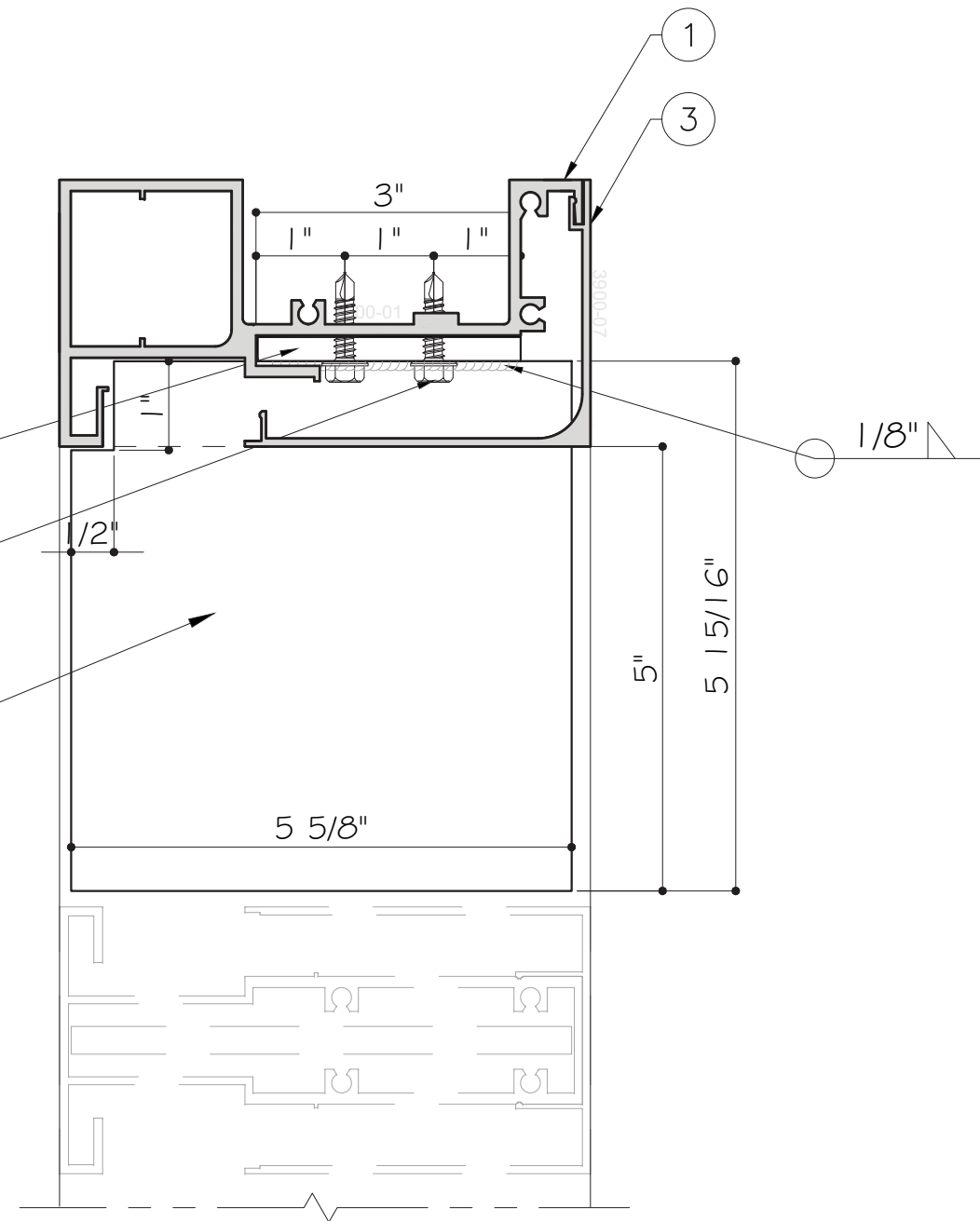

A DETAIL
A

YIPING WANG, P.E.
FLORIDA REGISTRATION
No. 555983
FL #55983
C.N. 78917
STATE OF FLORIDA
PROFESSIONAL ENGINEER
AUGUST 18th, 2017

MCY ENGINEERING, INC.
GLAZING CONSULTANTS
8501 SW 124 Ave, Ste. 205A
MIAMI, FL 33183
P: 305.271.0117
www.MCYEngineering.com
MCY.Engineering@Alt.net

SYSTEM 3060 WINDOW WALL - S.M.I.
CONTINENTAL GLASS SYSTEMS, INC.
325 WEST 74 PLACE, HIALEAH, FL 33014
TEL: (305) 231-1101 FAX: (305) 231-1103

Rev. No.	Date	Drawn By	Description

Drawn Date: 07/27/2017
Scale:
FL #22012
DRAWING NO. AD17-09
D4
Sheet No. 12 OF 15

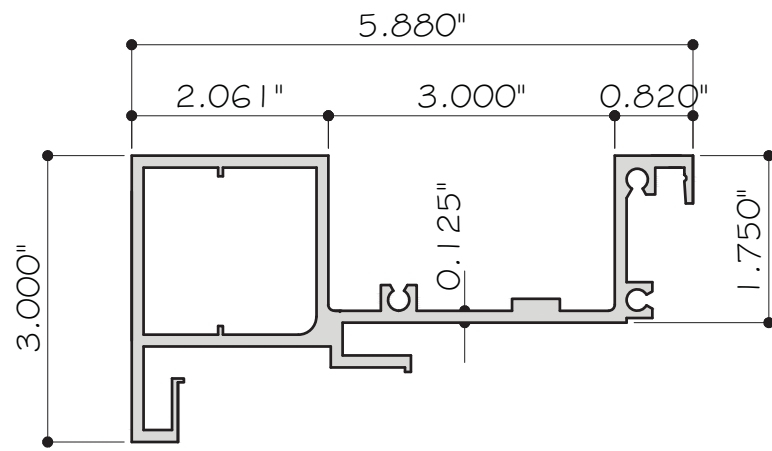

1 HEAD & SILL
3900-01 ALUM. 6005A-T6 I

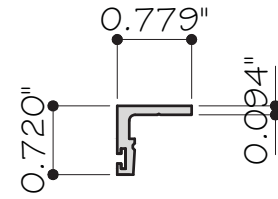

2 GLAZING BEAD
3900-03 ALUM. 6005A-T6 I

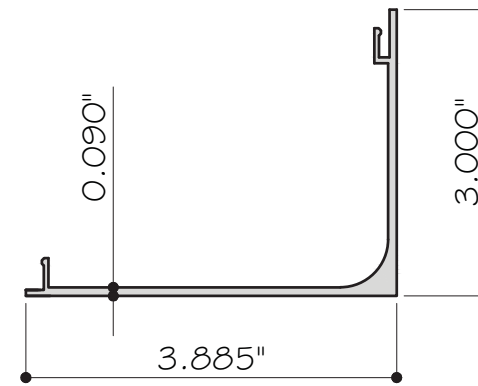

3 COVER
3900-07 ALUM. 6063-T6

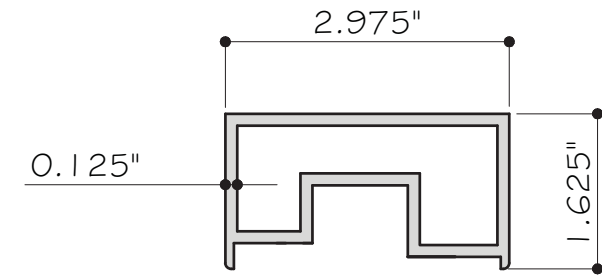

4 ADJUSTER
3900-08 ALUM. 6005A-T6 I

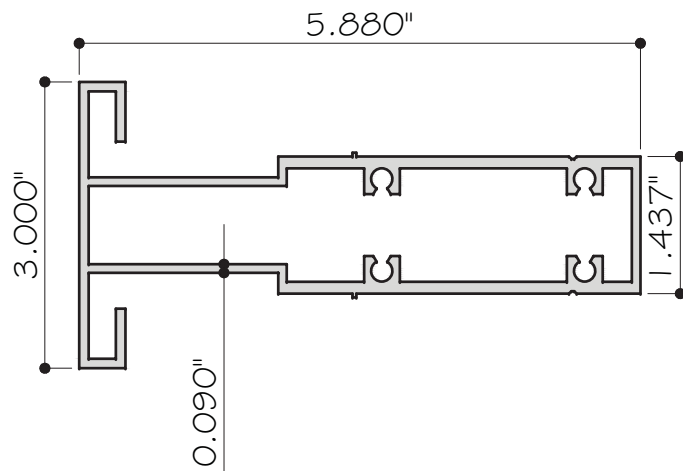

5 INTERMEDIATE
3900-14 ALUM. 6005A-T6 I

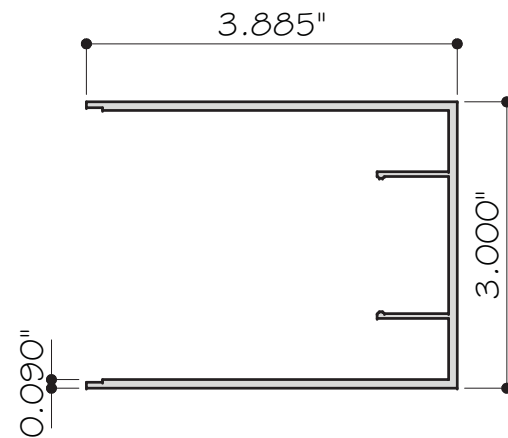

6 INTERMEDIATE COVER
3900-15 ALUM. 6063-T6

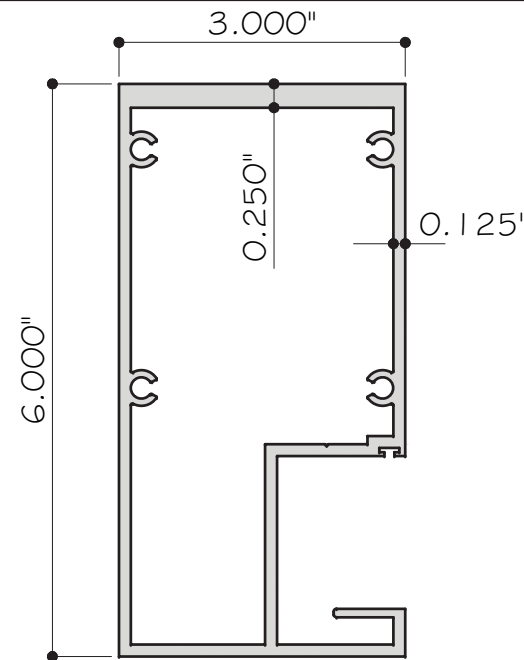

7 JAMB
3900-04 ALUM. 6005A-T6 I

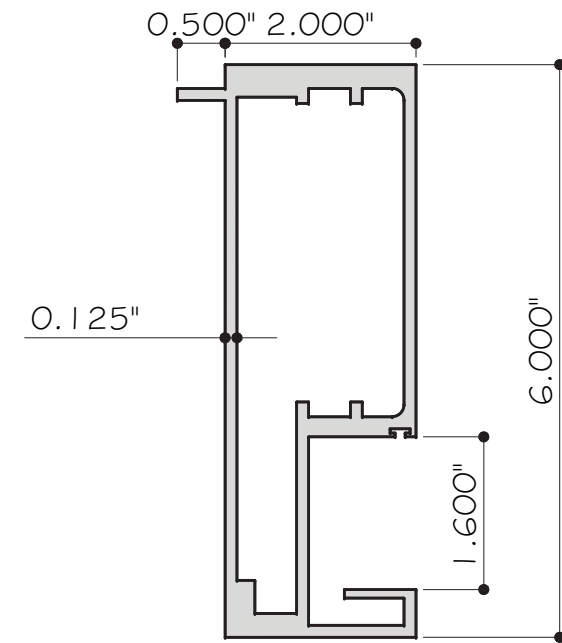

8 JAMB IN
3060-06 ALUM. 6005A-T6 I

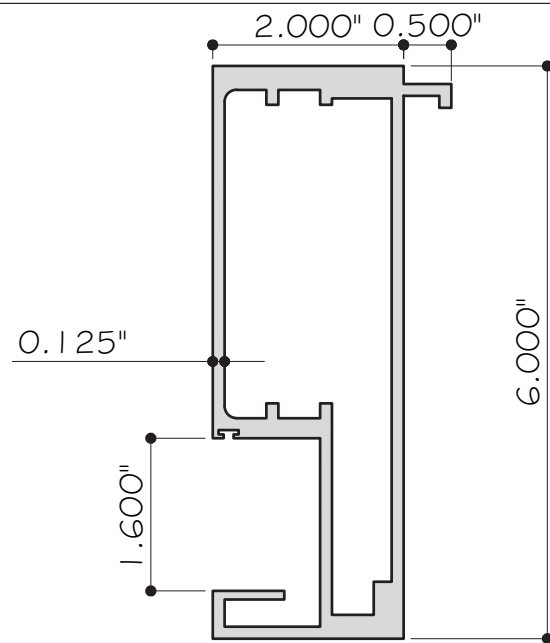

9 JAMB OUT MALE
3060-04 ALUM. 6005A-T6 I

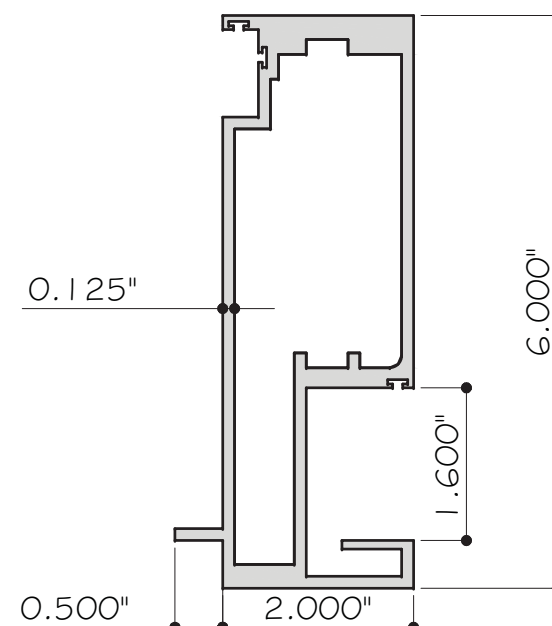

10 JAMB OUT FEMALE
3060-05 ALUM. 6005A-T6 I

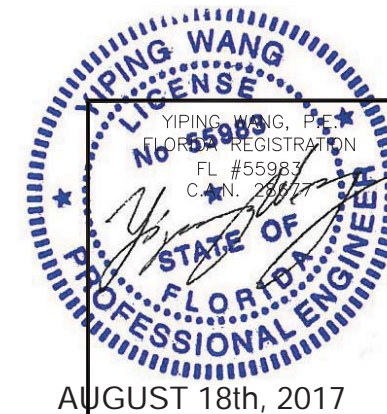

MCY ENGINEERING, INC.
GLAZING CONSULTANTS
8501 SW 124 Ave. Ste. 205A
MIAMI, FL 33183
P: 305.271.0117
www.MCYEngineering.com
MCY.Engineering@All.net

SYSTEM 3060 WINDOW WALL - S.M.I.
CONTINENTAL GLASS SYSTEMS, INC.
325 WEST 74 PLACE, HIALEAH, FL 33014
TEL: (305) 231-1101 FAX: (305) 231-1103

Rev. No.	Date	Drawn By	Description

Drawn Date: 07/27/2017
Scale:
FL #22012
DRAWING NO. AD17-09
PARTS
Sheet No. 13 OF 15

BILL OF MATERIALS

ITEM	PART	DESCRIPTION	MATERIAL	REMARKS
1	3900-01	HEAD & SILL	ALUM. 6005A-T6 I	-
2	3900-03	GLAZING BEAD	ALUM. 6005A-T6 I	-
3	3900-07	COVER	ALUM. 6063-T6	-
4	3900-08	ADJUSTER	ALUM. 6005A-T6 I	-
5	3900-14	INTERMEDIATE	ALUM. 6005A-T6 I	-
6	3900-15	INTERMEDIATE COVER	ALUM. 6063-T6	-
7	3900-04	JAMB	ALUM. 6005A-T6 I	-
8	3060-06	JAMB IN	ALUM. 6005A-T6 I	-
9	3060-04	JAMB OUT MALE	ALUM. 6005A-T6 I	-
10	3060-05	JAMB OUT FEMALE	ALUM. 6005A-T6 I	-
11	DC983 OR DC995	STRUCTURAL SEALANT DC983 OR DC995	SILICONE	DOW CORNING
12	DC795	CONT. SEALANT DOW CORNING 795 & BACKER ROD	SILICONE	DOW CORNING
13	-	SETTING BLOCK	SILICONE	-
14	-	GASKET	POLYPROPYLENE/SANTOPRENE	-
15	-	1/2" X 4-1/2" STEEL BAR REINFORCEMENT	STEEL, A36 MIN.	-
16	-	1/2" X 5" STEEL BAR REINFORCEMENT	STEEL, A36 MIN.	-
17	-	3/4" X 5-1/2" STEEL BAR REINFORCEMENT	STEEL, A36 MIN.	-
18	-	5/16" X 5-5/8" ALUM. BAR REINFORCEMENT	ALUM.	-
19	-	GLAZING SPACER	ALUM.	-

MCY ENGINEERING, INC.
GLAZING CONSULTANTS

8501 SW 124 Ave., Ste. 205A
MIAMI, FL 33183 P: 305.271.0117



www.MCYEngineering.com

SYSTEM 3060 WINDOW WALL - S.M.I.

CONTINENTAL GLASS SYSTEMS, INC.
325 WEST 74 PLACE, HIALEAH, FL 33014
TEL: (305) 231-1101 FAX: (305) 231-1103

Rev. No.	Date	Drawn By	Description

Drawn Date 07/27/2017	Scale
FL #22012	
DRAWING NO.	
AD17-09	
BOM	
Sheet No.	
14 OF 15	

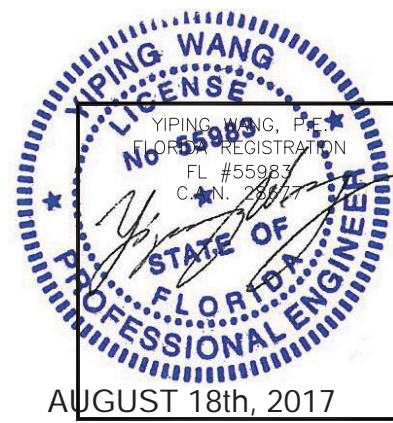

AUGUST 18th, 2017

#14 X 1" LG.
SS SMS

#14 X 1" LG.
SS SMS

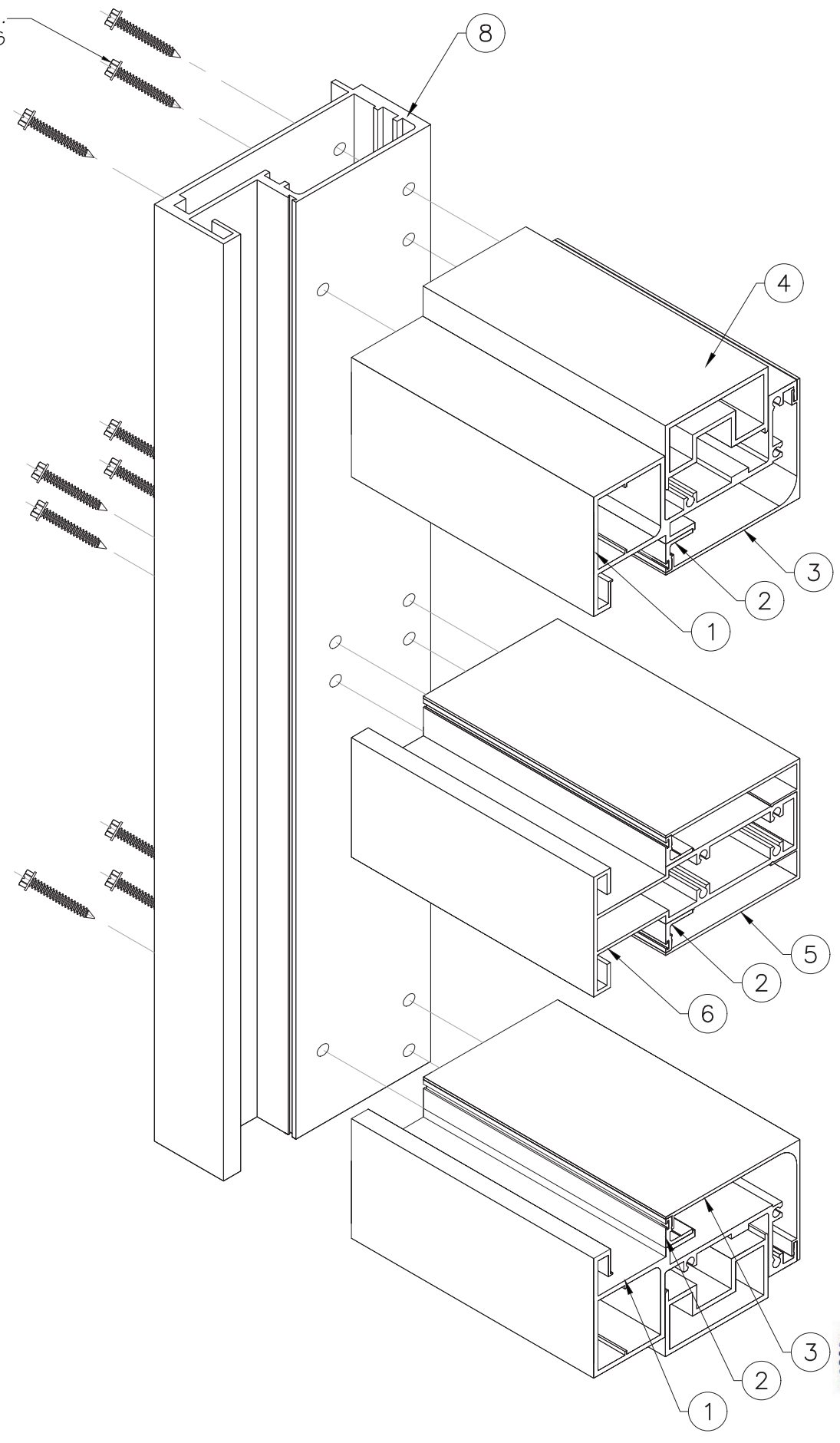
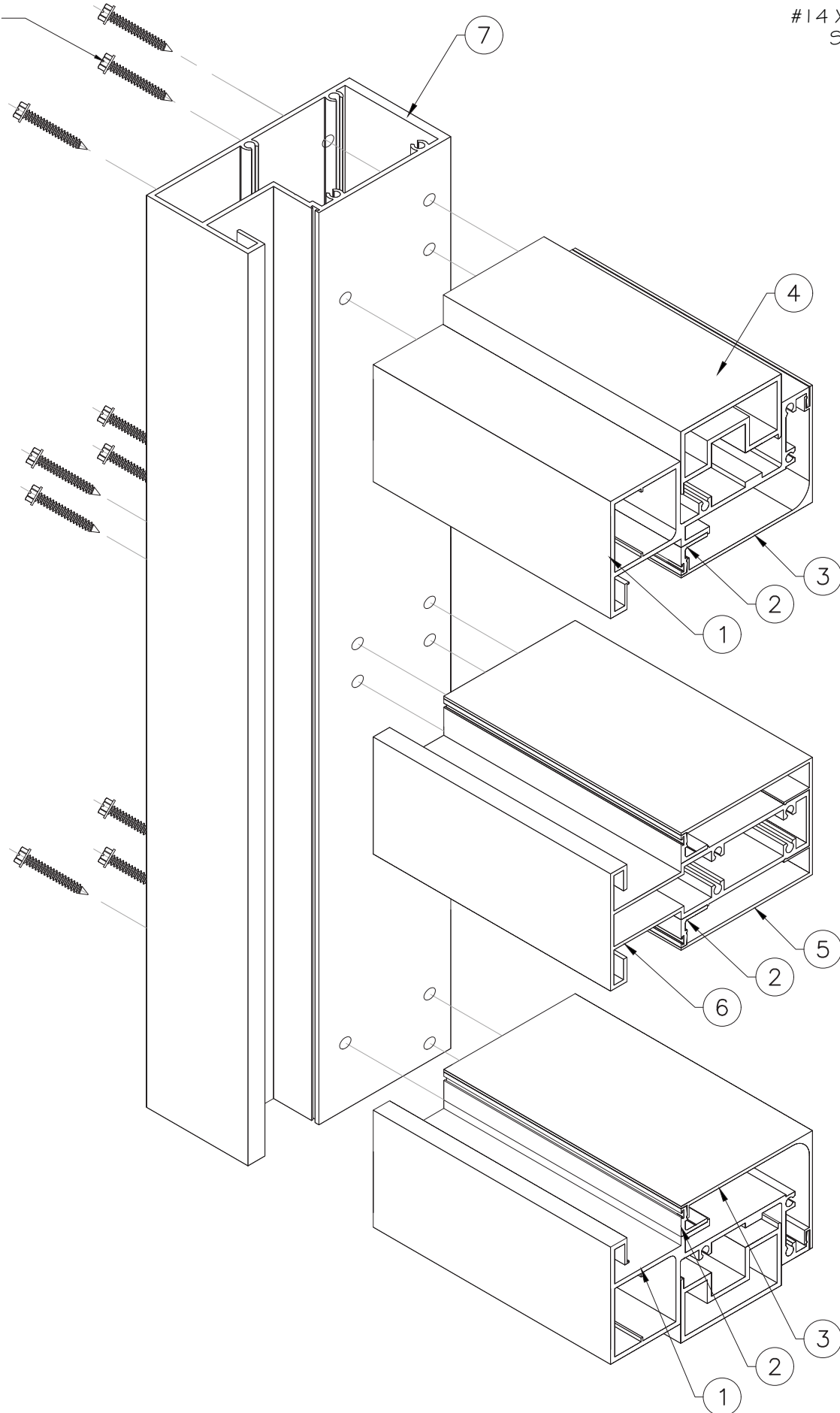

HORIZONTAL TO VERTICAL ASSEMBLY

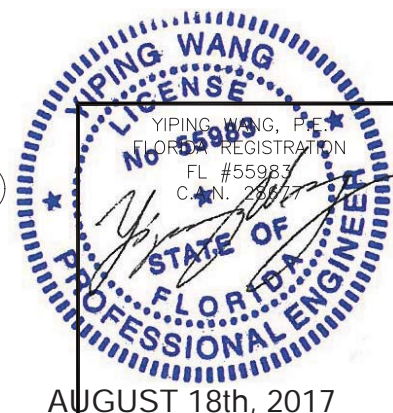

AUGUST 18th, 2017

MCY ENGINEERING, INC.
 GLAZING CONSULTANTS
MCY
 8501 SW 124 Ave, Ste. 205A
 MIAMI, FL 33183
 P: 305.271.0117
 www.MCYEngineering.com
 MCY.Engineering@Alt.net

SYSTEM 3060 WINDOW WALL - S.M.I.
CONTINENTAL GLASS SYSTEMS, INC.
 325 WEST 74 PLACE, HIALEAH, FL 33014
 TEL: (305) 231-1101 FAX: (305) 231-1103

Rev. No.	Date	Drawn By	Description

Drawn Date: 07/27/2017 Scale:

FL #22012
 DRAWING NO.
 AD17-09
 ISO
 Sheet No.
 15 OF 15